

REV.	DESCRIPTION	DATE
A	RELEASED	04/10/03
E	Change Dimension	08/30-'12
F	Modify Insertion Force & Withdrawal Force	10/01-'14

Pin NO.	Power Name	Pin NO.	Power Name
P1	V33	P9	V5
P2	V33	P10	GND
P3	V33	P11	DAS/DSS
P4	GND	P12	GND
P5	GND	P13	V12
P6	GND	P14	V12
P7	V5	P15	V12
P8	V5		

Pin NO.	Signal Name
S1	GND
S2	A+
S3	A-
S4	GND
S5	GND
S6	B+
S7	GND

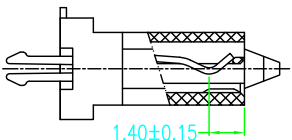

SECTION A-A

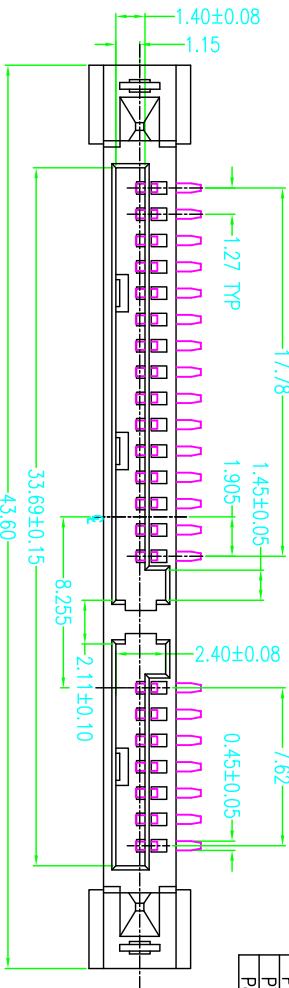

Notes:

\*Material

Housing: LCP, UL94 V-0; Color: Black  
Contact: Phosphor Bronze  
Plating: Au Plating On Contact Area,  
Sn(100u" Min.) Plating On Solder Tail,  
Ni(40u" Min.) Underplating Overall.

Harpoon: Brass  
Plating: Sn(100u"Min)Plating Over Ni(50u"Min)

\*Mechanical

Insertion Force: 20N Max.  
Withdrawal Force: 4N Min.  
Durability: 500 Cycles

\*Electrical Specification

Current Rating: 1.5 Ampere Per Contact  
Contact Resistance: 30mΩ Max.  
Insulation Resistance: 1000MΩ Min.  
Dielectric Withstanding Voltage: 500V AC

\*Environmental

Operating Temperature: -55°C To +85°C

\*How to Order

HSAT-F22-V5S-00

Au F:Flash 5:15u" 3:30u"

NO. Of Contacts

Series No.

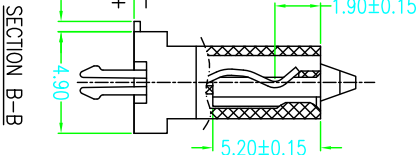

SECTION B-B

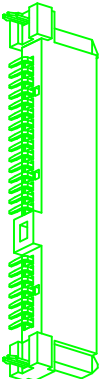
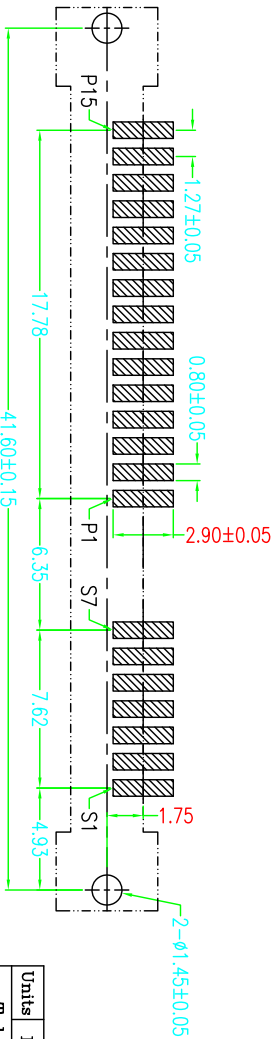
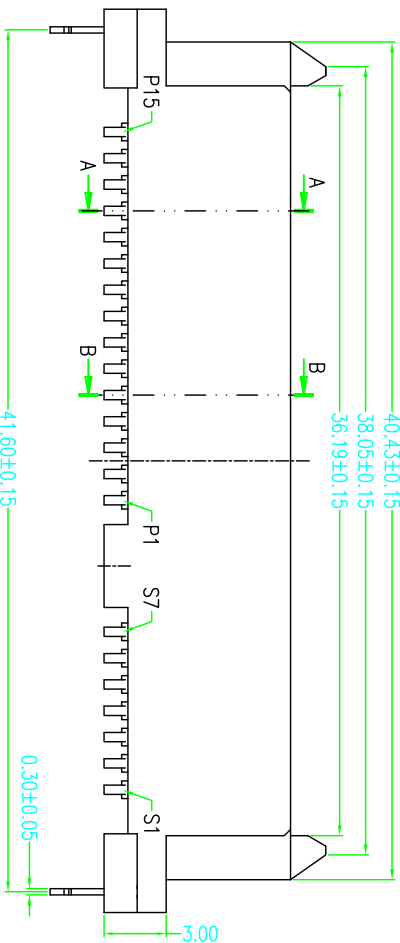

Units	mm	Scale
Tolerance Unless Otherwise Specified		
.X	±0.35	
.XX	±0.25	
.XXX	±0.15	
Angle	± 3°	

Drawing By	Data
Jack	10/01-'14
Reviewed By	Data
Sharon	10/01-'14
Approval By	Data
Jason	10/02-'14

益 富 科 技 有 限 公 司	
TEL 886-3-5511680 FAX 886-3-5511605	
Date	10/01-'14
Sheet	1 of 1
Title	
SATA 7+15P SMT Type, Vertical Female	

PCB LAYOUT(I=1.60mm)  
COMPONENT SIDE